

LOUD SPEAKER (INTERNAL MAGNET TYPE)

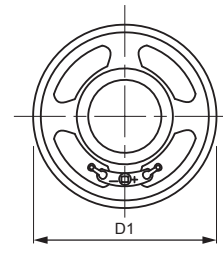
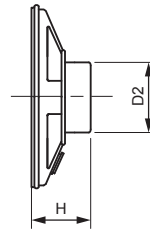

Unit : mm

Electrical Specifications

Part Number	D1 [mm]	D2 [mm]	H [mm]	Imp. [ohm]	Rated Power [W]	Resonant Freq. [Hz]	Sound Output [dB]	Shape	Frame
LI3617-8R	36	18	16.5	8	0.5	280 +/- 20%	81	Round	Metal
LI4011-50R	40	18.3	10.6	50	0.25	600 +/- 20%	78	Round	Metal
LI4510-40R	45	18.2	9.5	40	0.25	680 +/- 20%	84	Round	Metal
LI5012-8R	50	19.3	12	8	0.25	540 +/- 20%	86	Round	Metal
LI5009-8R	50	15.5	8.5	8	1.5	500 +/- 20%	80	Round	Metal
LI5013-32R	50	18	13	32	0.25	450 +/- 20%	86	Round	Metal
LI5009-8RW	50	15.5	8.5	8	0.25	500 +/- 20%	83	Round	Metal
LI5012-25R	50	18	12	25	0.25	360 +/- 20%	86	Round	Metal
LI5009-8RWC	50	17	8.9	8	1	550 +/- 20%	84	Round	Metal
LI5012-8RW	50	18	12	8	2	800 +/- 20%	85	Round	Metal
LI5112-100S	50.5	18	12	100	0.5	450 +/- 20%	85	Square	Metal w/ 4 holes
LI5012-50R	50	18	12	50	0.5	500 +/- 20%	85	Round	Metal
LI5019-16RWC	50	22	18.5	16	1	500 +/- 20%	83	Round	Metal
LI5012-22R	50	18	12	22	0.5	500 +/- 20%	87	Round	Metal
LI5012-8RWC	50	17.3	12	8	0.5	450 +/- 20%	85	Round	Metal
LI5013-8R	50	18	12.5	8	0.5	450 +/- 20%	85	Round	Metal
LI5713-25R	57	18.5	13.3	25	0.5	350 +/- 20%	89	Round	Metal
LI5719-8R	57	22	19	8	0.2	400 +/- 20%	83	Round	Metal
LI5714-8R	57	18	13.5	8	0.5	450 +/- 20%	88	Round	Metal
LI5713-32R	57	18.5	13	32	0.25	380 +/- 20%	90	Round	Metal
LI5713-8R	57	18	13	8	0.5	380 +/- 20%	86	Round	Metal
LI5713-8RW	57	18	13.1	8	0.5	400 +/- 20%	86	Round	Metal
LI5720-32R	57	22	19.5	32	0.5	400 +/- 20%	85	Round	Metal
LI5710-8R	57	17	9.5	8	0.25	450 +/- 20%	85	Round	Metal
LI6622-8R	66	22	22	8	0.3	350 +/- 20%	87	Round	Metal
LI6619-8R	66	22	19	8	0.5	360 +/- 20%	84	Round	Metal
LI7718-8R	77	18	17.5	8	1	300 +/- 20%	86	Round	Metal
LI7723-32RW	77	22	23	32	1	250 +/- 20%	85	Round	Metal
LI7727-16R	78	22	27	16	3	250 +/- 20%	86	Round	Metal
LI10236-4S	102	22	36	4	2	180 +/- 20%	88	Square	Metal w/ 4 holes
LI251505-16E-P	25 * 15	11.3	5	16	0.5	900 +/- 20%	82	Rectangular	Plastic w/ 4 holes
LI251506-8E-P	25 * 15	11	5.5	8	0.5	900 +/- 20%	82	Rectangular	Plastic w/ 2 holes
LI351606-8E-P	35 * 16	11.35	5.5	8	1	600 +/- 20%	83	Rectangular	Plastic w/ 4 holes
LI351606-16E-P	35 * 16	11.35	5.5	16	1	600 +/- 20%	83	Rectangular	Plastic w/ 4 holes
LI351607-4E-P	35 * 16	11.3	6.7	4	1	600 +/- 20%	86	Rectangular	Plastic w/ 4 holes
LI402008-8E-P	40 * 20	14.8	8	8	1	650 +/- 20%	85	Rectangular	Plastic w/ 4 holes
LI402008-4E-P	40 * 20	14.7	7.8	4	1	650 +/- 20%	84	Rectangular	Plastic w/ 4 holes
LI402006-8E	40 * 20	14.2	6	8	1	600 +/- 20%	83	Rectangular	Metal w/ 4 holes
LI402006-8EW	40 * 20	14.3	5.8	8	2	500 +/- 20%	79	Rectangular	Metal w/ 4 holes
LI402006-8EWC	40 * 20	14.3	5.8	8	2	400 +/- 20%	83	Rectangular	Metal w/ 4 holes
LI402008-8E-P	40 * 20	14.7	7.8	8	1	650 +/- 20%	84	Rectangular	Plastic w/ 4 holes
LI402813-8E-P	40 * 28.4	16.8	12.5	8	1	300 +/- 20%	82	Rectangular	Plastic w/ 4 holes
LI905038-16E	90 * 50	38	37.5	16	5	180 +/- 20%	86	Rectangular	Metal w/ 4 holes
LI905042-8E	90 * 50	48	42	8	10	200 +/- 20%	85	Rectangular	Metal w/ 4 holes
LI905042-4E	90 * 50	48	42	4	10	200 +/- 20%	90	Rectangular	Metal w/ 4 holes
LI905036-4E	90 * 50	38	36	4	3	200 +/- 20%	88	Rectangular	Metal w/ 4 holes

Remark: The above mentioned data is standardized. We could also tailor made the Speaker Elements for the customers.

LOUD SPEAKER (EXTERNAL MAGNET TYPE)

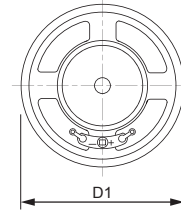
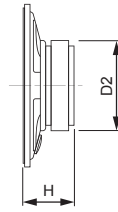

Electrical Specifications

Unit : mm

Part Number	D1 [mm]	D2 [mm]	H [mm]	Imp. [ohm]	Rated Power [W]	Resonant Freq. [Hz]	Sound Output [dB]	Shape	Frame
LE4015-8R	40	27	14.5	8	0.2	800 +/- 20%	80	Round	Metal
LE4016-8R-P	40	32	16	8	0.25	600 +/- 20%	84	Round	Plastic
LE4515-8R	45	32	15	8	0.25	700 +/- 20%	92	Round	Metal
LE4515-8RWC	45	32	15	8	0.5	600 +/- 20%	85	Round	Metal
LE5016-32RW	50	32	16	32	0.25	400 +/- 25%	86	Round	Metal
LE5016-32R	50	32	16	32	0.5	530 +/- 20%	84	Round	Metal
LE5017-8R	50	32	17	8	0.25	450 +/- 20%	80	Round	Metal
LE5016-8R	50	32	16	8	0.25	550 +/- 20%	92	Round	Metal
LE5016-16R	50	32	16	16	0.25	460 +/- 20%	90	Round	Metal
LE5016-8RW	50	32	16	8	0.5	500 +/- 20%	85	Round	Metal
LE5016-50R	50	32	16	50	0.5	500 +/- 20%	82	Round	Metal
LE5017-8RW	50	32	17	8	0.5	450 +/- 20%	88	Round	Metal
LE5016-45R	50	32	16	45	0.25	450 +/- 20%	82	Round	Metal
LE5015-8R	50	32	15	8	1	550 +/- 20%	85	Round	Metal
LE5717-8R	57	32	17	8	0.25	450 +/- 20%	82	Round	Metal
LE5718-8R	57	32	18	8	0.5	500 +/- 20%	85	Round	Metal
LE5718-16R	57	32	18	16	1	450 +/- 20%	78	Round	Metal
LE5717-50R	57	36	17	50	0.5	450 +/- 20%	84	Round	Metal
LE5718-50R	57	36	17.5	50	0.5	460 +/- 20%	83	Round	Metal
LE5717-50RW	57	32	17	50	0.25	430 +/- 20%	83	Round	Metal
LE5717-50RWC	57	32	17	50	0.25	400 +/- 20%	88	Round	Metal
LE5718-32R	57	36	17.5	32	0.5	460 +/- 20%	83	Round	Metal
LE6629-8R	66	45	28.8	8	5	450 +/- 11%	92	Round	Metal
LE6620-8R	66	32	20	8	1	280 +/- 20%	85	Round	Metal
LE6621-8R	66	32	21	8	0.5	350 +/- 20%	85	Round	Metal
LE6619-64R	66	32	19	64	0.5	280 +/- 20%	90	Round	Metal
LE6623-64R	66	32	22.5	64	0.2	550 +/- 20%	83	Round	Metal
LE6619-8R	66	32	19	8	1	350 +/- 20%	86	Round	Metal
LE6619-25R	66	32	19	25	0.3	400 +/- 20%	86	Round	Metal
LE7020-8R	70	32	19.5	8	0.5	320 +/- 20%	87	Round	Metal
LE7022-4R	70	35	21.5	4	1	200 +/- 20%	89	Round	Metal
LE7721-8R	77	32	21	8	1	350 +/- 20%	87	Round	Metal
LE7722-4R	77	32	22	4	1	300 +/- 20%	85	Round	Metal
LE7730-8R	77	40	29.6	8	3	150 +/- 20%	85	Round	Metal
LE7733-6R	77	45	32.5	6	3	185 +/- 20%	92	Round	Metal
LE7938-4S	79	51	38	4	7	115 +/- 20%	87	Square	Metal w/ 4 holes
LE8633-8S	86	60	33	8	8	450 +/- 20%	90	Square	Metal w/ 4 holes
LE10230-4R	102	45	30	4	3	200 +/- 20%	90	Round	Metal
LE10230-8R	102	45	30	8	3	200 +/- 20%	85	Round	Metal
LE10235-4S	102	40	35	4	2	140 +/- 20%	88	Square	Metal w/ 4 holes
LE10236-8R	102	45	35.5	8	2	140 +/- 20%	87	Round	Metal
LE10235-8S	102	45	34.5	8	3	210 +/- 20%	86	Square	Metal w/ 4 holes

Remark: The above mentioned data is standardized. We could also tailor made the Speaker Elements for the customers.