

Piezo Transducer

KPT-G2260 PIEZO TRANSDUCER

FREQUENCY RESPONSE
[actual curve of type]

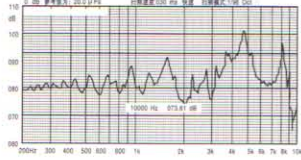

Model No	KPT-G2260
Rated Voltage	10Vp-p Square Wave
Max Allowable Voltage	30Vp-p Square Wave
Max Rated Current	6mA
Min.Sound Pressure Level	84dB/12Vp-p Square Wave/4.0KHz/10cm
Capacitance at 100HZ	14000 ± 30%PF
Resonant Frequency	4.0 ± 0.5KHz
Tone Nature	Continuous
Operating Temperature	-20 ~ +85°C
Storage Temperature	-40 ~ +95°C
Weight	2.5g

RoHS
Compliant



DIMENSIONS

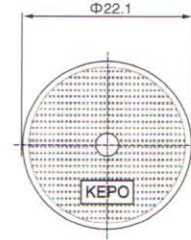
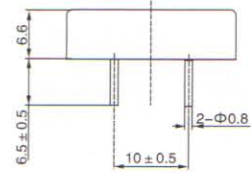

color Black
PC Housing Material
Pin Terminal

KPT-G2310 PIEZO TRANSDUCER

FREQUENCY RESPONSE
[actual curve of type]

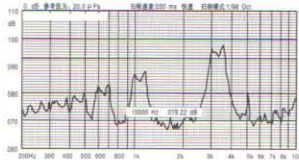

Model No	KPT-G2310
Rated Voltage	12Vp-p Square Wave
Max Allowable Voltage	30Vp-p Square Wave
Max Rated Current	4mA
Min.Sound Pressure Level	85dB/12Vp-p Square Wave/3.3KHz/10cm
Capacitance at 100HZ	15000 ± 30%PF
Resonant Frequency	3.3 ± 0.5KHz
Tone Nature	Continuous
Operating Temperature	-20 ~ +60°C
Storage Temperature	-30 ~ +70°C
Weight	3.5g

RoHS
Compliant



DIMENSIONS

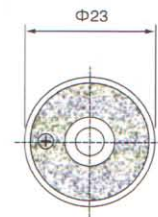
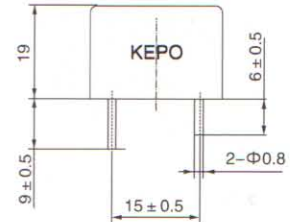

color Black
ABS Housing Material
Pin Terminal

KPT-G2311 PIEZO TRANSDUCER

FREQUENCY RESPONSE
[actual curve of type]

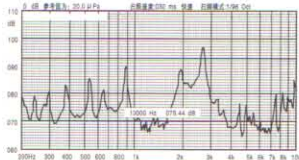

Model No	KPT-G2311
Rated Voltage	3Vrms Sine Wave
Max Allowable Voltage	30Vp-p Square Wave
Max Rated Current	2mA
Min.Sound Pressure Level	75dB/3Vrms Sine Wave/2.0KHz/10cm
Capacitance at 100HZ	30000 ± 30%PF
Resonant Frequency	2.0 ± 0.5KHz
Tone Nature	Continuous
Operating Temperature	-20 ~ +80°C
Storage Temperature	-30 ~ +100°C
Weight	3g

RoHS
Compliant



DIMENSIONS

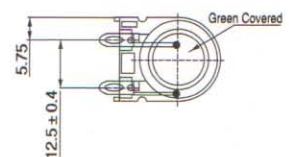
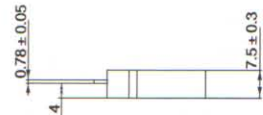
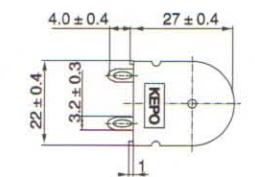

color Black
PC Housing Material
Pin Terminal

The information contained herein is believed to be correct, but no guarantee for accuracy, completeness KEPO Electronics Ltd. reserves the right to make changes without notification.