

## MINI DIN SOCKET UNSHIELDED TYPE (2)

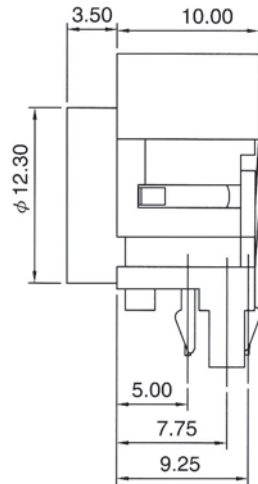
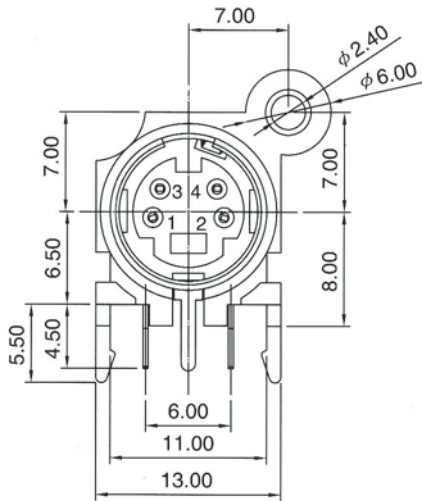

### SPECIFICATIONS

1. **Rating:** 100VAC 1A (max.)  
12VDC 2A (max.)
2. **Dielectric withstanding voltage:**  
500VAC, 60Hz for 1 minute
3. **Insulation resistance (initial):**  
100MΩ (min.) at 500V DC
4. **Contact resistance (initial):**  
30mΩ (max.) at AC 100mA (max.) 1 KHz
5. **Insertion & Extraction force:**  
Initial : 4.5kgs (max.)  
Extraction force: 0.9 to 3.0kgs

### MATERIALS

1. **Insulator:** PBT(Black, UL94V-0)
  2. **Contact:** Phosphor bronze.
  3. **Metal Shell:** Copper alloy
- All materials must be RoHS compliant.

7222-xxx

### ARRANGEMENT OF CONTACTS

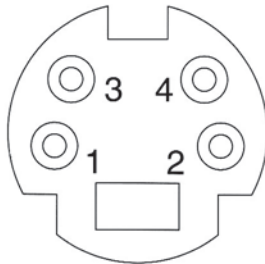

### HOLE LAYOUT

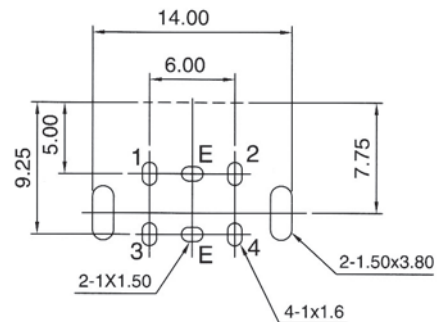

### ORDERING INFORMATION:

P/N 7 2 2 2 -  $\frac{\text{xxx}}{\text{I 2}}$

1. NO. OF CONTACTS:  
04
2. HOUSING COLOR:  
"B" BLACK

## MINI DIN CONNECTOR 7 PIN DOUBLE ROW TYPE

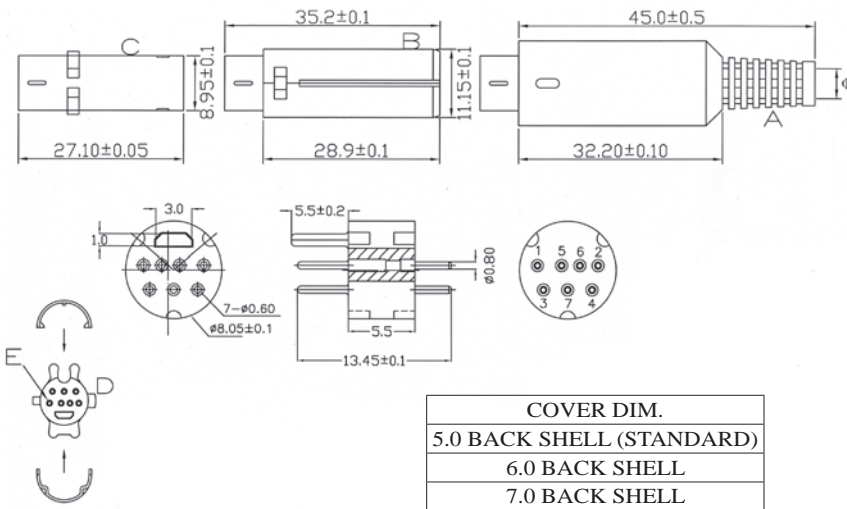

### SPECIFICATIONS

- Rating:** 100VAC 1A (max.)  
12VDC 2A (max.)
- Dielectric withstanding voltage:** 500VAC, 60Hz for 1 minute
- Insulation resistance (initial):** 100MΩ (min.) at 500V DC
- Contact resistance (initial):** 30mΩ (max.) at AC 100mA (max.) 1 KHz
- Insertion & Extraction force:**  
Initial : 4.5kgs (max.)  
Extraction force: 0.9 to 3.0kgs

### MATERIALS

- Insulator:** PBT(Black, UL94V-0)
  - Contact:** Phosphor bronze.
  - Metal Shell:** Copper alloy
- All materials must be RoHS compliant.

7283-07/7205-07/7206-07

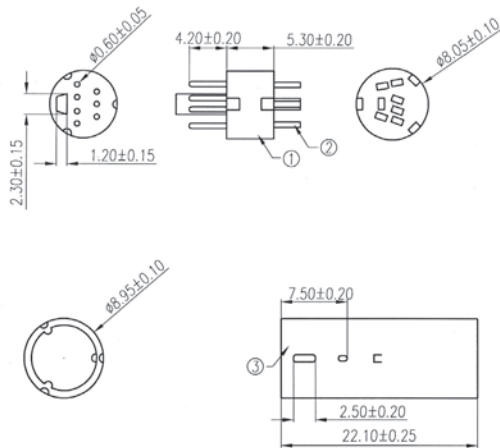

7283MD-07

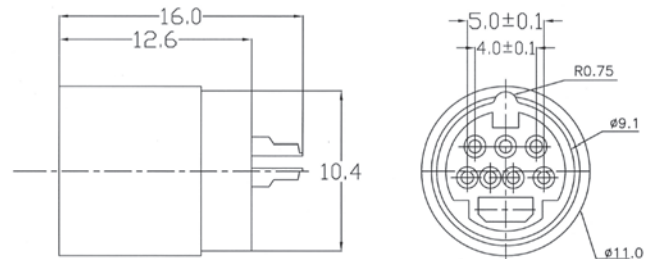

7284MD-07

## ORDERING INFORMATION:

P/N 72  $\frac{xx}{1}$  -  $\frac{07}{2}$

### 1. CONNECTOR TYPE:

- "83" MINI DIN PLUG ASSEMBLY TYPE  $\Phi$ 5.0MM
- "05" MINI DIN PLUG ASSEMBLY TYPE  $\Phi$ 6.0MM
- "06" MINI DIN PLUG ASSEMBLY TYPE  $\Phi$ 7.0MM
- "83MD" MINI DIN PLUG MOLDED TYPE (MALE)
- "84MD" MINI DIN JACK MOLDED TYPE (FEMALE)

### 2. NO. OF CONTACTS:

- "07" 7 PIN DOUBLE ROW TYPE

## MINI DIN 9 PIN CONNECTOR

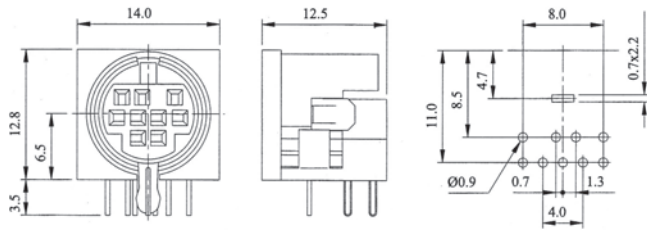

**7232-09**

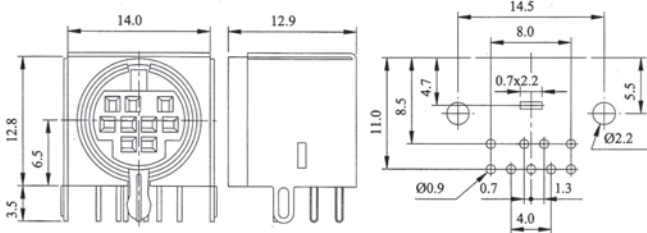

**7243-09**

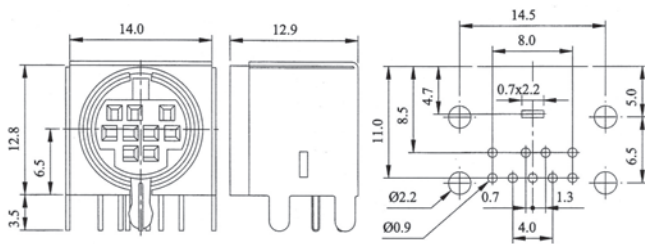

**7240-09**

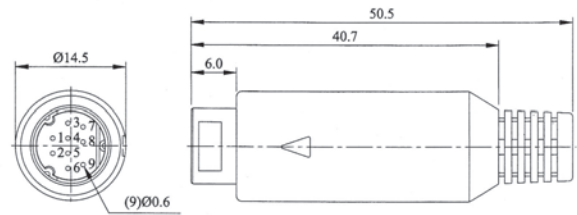

**7211-09**

### SPECIFICATIONS

1. **Rating:** 100VAC 1A (max.)  
12VDC 2A (max.)
2. **Dielectric withstanding voltage:**  
500VAC, 60Hz for 1 minute
3. **Insulation resistance (initial):**  
100MΩ (min.) at 500V DC
4. **Contact resistance (initial):**  
30mΩ (max.) at AC 100mA (max.) 1 KHz
5. **Insertion & Extraction force:**  
Initial : 4.5kgs (max.)  
Extraction force: 0.9 to 3.0kgs

### MATERIALS

1. **Insulator:** PBT(Black, UL94V-0)
  2. **Contact:** Phosphor bronze.
  3. **Metal Shell:** Copper alloy
- All materials must be RoHS compliant.

### ORDERING INFORMATION:

P/N 72  $\frac{xx}{I}$  -  $\frac{09}{2}$

1. CONNECTOR TYPE:  
"32" MINI DIN SOCKET  
"43" MINI DIN SOCKET SHIELD TYPE  
"40" MINI DIN SOCKET FULLY SHIELD TYPE  
"11" MINI DIN PLUG
2. NO. OF CONTACTS:  
09

NOTE: THE HOUSING COLOR IS BLACK.

## MINI DIN SOCKET WITH HOOK

P/N	Dimension (m/m)	Pin Hole Layout
72A1-04		
72A2-04		
72A3-04		

### ORDERING INFORMATION:

**P/N 72A1-04**

UNSHIELDED MINI DIN 4 PIN SOCKET

**P/N 72A2-04**

UNSHIELDED MINI DIN 4 PIN SOCKET

**P/N 72A3-04**

UNSHIELDED MINI DIN 4 PIN SOCKET

## DUAL PORT MINI DIN SOCKET FULLY SHIELDED TYPE

		<p><b>SPECIFICATIONS</b></p> <p><b>1. Rating:</b> 100VAC 1A (max.) 12VDC 2A (max.)</p> <p><b>2. Dielectric withstanding voltage:</b> 500VAC, 60Hz for 1 minute</p> <p><b>3. Insulation resistance (initial):</b> 100MΩ (min.) at 500V DC</p> <p><b>4. Contact resistance (initial):</b> 30mΩ (max.) at AC 100mA (max.) 1 KHz</p> <p><b>5. Insertion &amp; Extraction force:</b> Initial : 4.5kgs (max.) Extraction force: 0.9 to 3.0kgs</p> <p><b>MATERIALS</b></p> <p><b>1. Insulator:</b> PBT(Black, UL94V-0)</p> <p><b>2. Contact:</b> Phosphor bronze.</p> <p><b>3. Metal Shell:</b> Copper alloy</p> <p><b>All materials must be RoHS compliant.</b></p>				
<b>DP-Axxxx</b>		<b>DP-Bxxxx</b>				
<b>ARRANGEMENT OF CONTACTS</b>						<b>HOLE LAYOUT</b>
<b>NO OF CONTACTS</b>	<b>4P*4P</b>	<b>6P*6P</b>	<b>8P*8P</b>	<b>4P*8P</b>	<b>6P*8P</b>	<b>8P*8P</b>

### ORDERING INFORMATION:

**P/N DP -  $\frac{x}{1} \frac{xx}{2} \frac{xx}{3}$**

**1. CONNECTOR TYPE:**

"A" WITHOUT GROUNDING SHIELD  
"B" WITH GROUNDING SHIELD

**2. NO. OF CONTACTS(TOP\*BOTTOM):**

"44" 4P\*4P  
"66" 6P\*6P  
"88" 8P\*8P  
"48" 4P\*8P  
"68" 6P\*8P

**3. HOUSING COLOR:**

"BB" TOP: BLACK & BOTTOM: BLACK  
"NP" TOP: GREEN & BOTTOM: PURPLE

## DUAL PORT MINI DIN SOCKET UNSHIELDED TYPE

		<p><b>SPECIFICATIONS</b></p> <ol style="list-style-type: none"> <li><b>Rating:</b> 100VAC 1A (max.) 12VDC 2A (max.)</li> <li><b>Dielectric withstanding voltage:</b> 500VAC, 60Hz for 1 minute</li> <li><b>Insulation resistance (initial):</b> 100MΩ (min.) at 500V DC</li> <li><b>Contact resistance (initial):</b> 30mΩ (max.) at AC 100mA (max.) 1 KHz</li> <li><b>Insertion &amp; Extraction force:</b> Initial : 4.5kgs (max.) Extraction force: 0.9 to 3.0kgs</li> </ol> <p><b>MATERIALS</b></p> <ol style="list-style-type: none"> <li><b>Insulator:</b> PBT(Black, UL94V-0)</li> <li><b>Contact:</b> Phosphor bronze.</li> <li><b>Metal Shell:</b> Copper alloy</li> </ol> <p>All materials must be RoHS compliant.</p>
<b>DP-Cxxxx</b>	<b>DP-Dxxxx</b>	
<b>ARRANGEMENT OF CONTACTS</b>	<b>HOLE LAYOUT</b>	
	<b>DP-Cxxxx</b>	<b>DP-Dxxxx</b>

### ORDERING INFORMATION:

P/N DP -  $\frac{x}{1} \frac{xx}{2} \frac{xx}{3}$

- CONNECTOR TYPE:  
"C" WITHOUT GROUNDING SHIELD  
"D" WITH GROUNDING SHIELD
- NO. OF CONTACTS:  
04
- HOUSING COLOR:  
"BB" TOP: BLACK & BOTTOM: BLACK

## MINI DIN SOCKET WITH 3.5MM AUDIO JACK

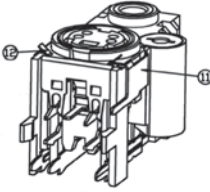
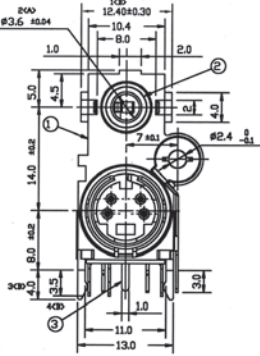
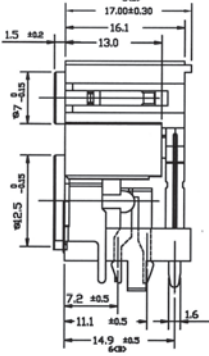
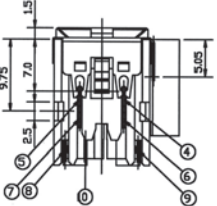
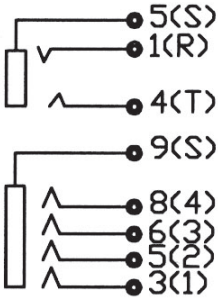
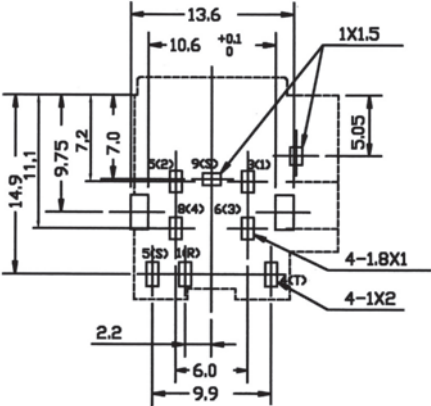
P/N	Dimension (m/m)
72A5-04 72A6-04	   
Schematic Code	Pin Hole Layout
	

### ORDERING INFORMATION:

**P/N 72A5-04**

MINI DIN 4 PIN SOCKET WITH 3.5MM MONO JACK

**P/N 72A6-04**

MINI DIN 4 PIN SOCKET WITH 3.5MM STEREO JACK