

Accessories for part front panels

Contact spring

- made of phosphorus bronze is mounted between die-cast PC-bracket VS 3-7 → N 59 and electrically conductive front panel
- serves as capacitive contact as well as for electrostatic discharge **ESD**
- electrical contact is achieved by conductive (chrome-free transparent passivated) module rails

1 = front panel; 2 = bracket; 3 = contact spring; 4 = module rail

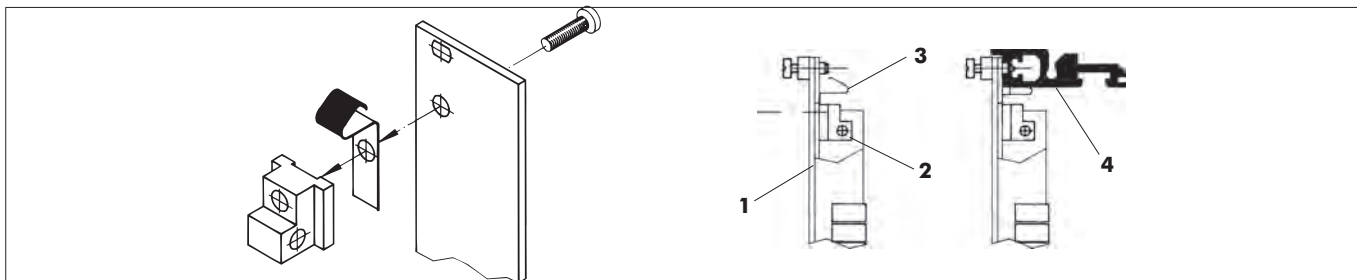

art. no.
FEK 1

Mounting material

- for locking insert modules and part front panels into the subrack
- **KN 1**: plastic sleeves for clipping in
- **MN 1**: metal sleeves / **MN 2**: metal sleeves for pressing in; fixed connection to the front panel
- **HS 1**: captive screw, brass nickel plated / **RS 1**: knurled screw with slot, brass nickel plated
- **VPE**: packing unit

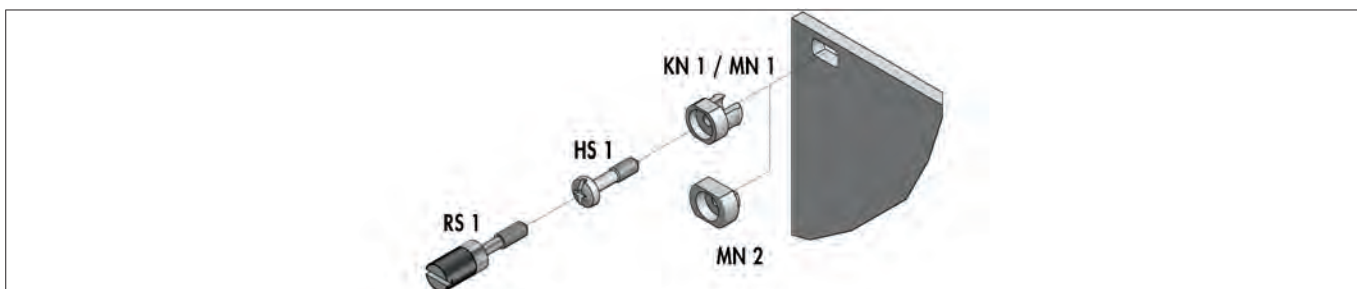

art. no.	VPE	
HS 1	100 pcs./bag	
KN 1	100 pcs./bag	
MN 1	10 pcs./bag	
MN 2	10 pcs./bag	
RS 1	100 pcs./bag	
	HS 1/ MN 1+2/ RS 1	KN 1
material	brass, nickel plated	polyamide

Extractors

- the extractors allow easy removal of PCBs from subracks without damaging the connector pins
- wobbling out damages the connector
- the different colours avoid incorrect insertion
- the extractor is fastened to the PCB by using of a fixing pin
- **minimum order quantity:** 10 sets
- further packing units on request
- 1 Set of 1 pc. AHG red, 1 pc. AHG black, 2 pcs. spring pins 2 x 6 mm

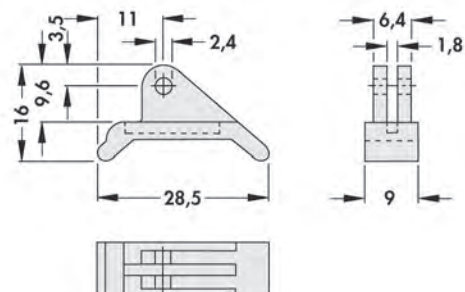

art. no.	
AHG 12 S	
material:	PBT, self-extinguishing

A
B
C
D
E
F
G
H
I
K
L
M
N



Threaded rails M 2.5

- threaded rails tapped to M 2.5 for mounting of fixing rails and front panels
- 1 set contains 4 threaded rails
- **HP** = width unit = 5.08 mm

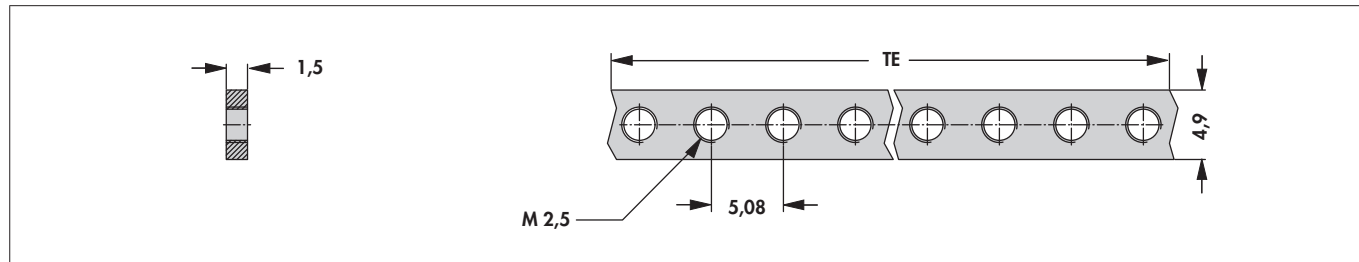

art. no.	HP	dim. [mm]
BGT 308 2	8	40.6
BGT 318 2	18	91.4
BGT 321 2	21	106.7
BGT 328 2	28	142.2
BGT 360 2	60	304.8
BGT 363 2	63	320.0
BGT 381 2	81	411.5
BGT 384 2	84	426.7

Threaded rails M 3

- threaded rails tapped to M 3; for mounting of fixing rails and front panels
- 1 set contains 4 threaded rails
- **HP** = 5.08 mm

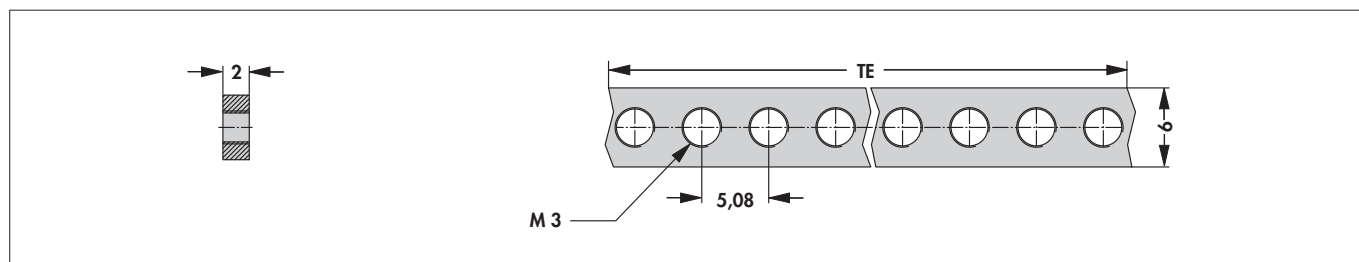

art. no.	HP	dim. [mm]
BGT 381 9	81	411.5
BGT 384 9	84	426.7