

## 19" system cases for EMC application

- the system case RACKCASE is suitable for EMC applications
- all metallically conductive contact surfaces are transparent passivated
- **test procedure:** in conformity with VG norm 95373, Part 15
- **article tested:** system case RACKCASE, 3 U, 84 HP, 280 mm deep, with closed rear and front panel and ventilation slots in the cover and bottom panel; rear and front panel electrically connected to the sides by means of contact springs

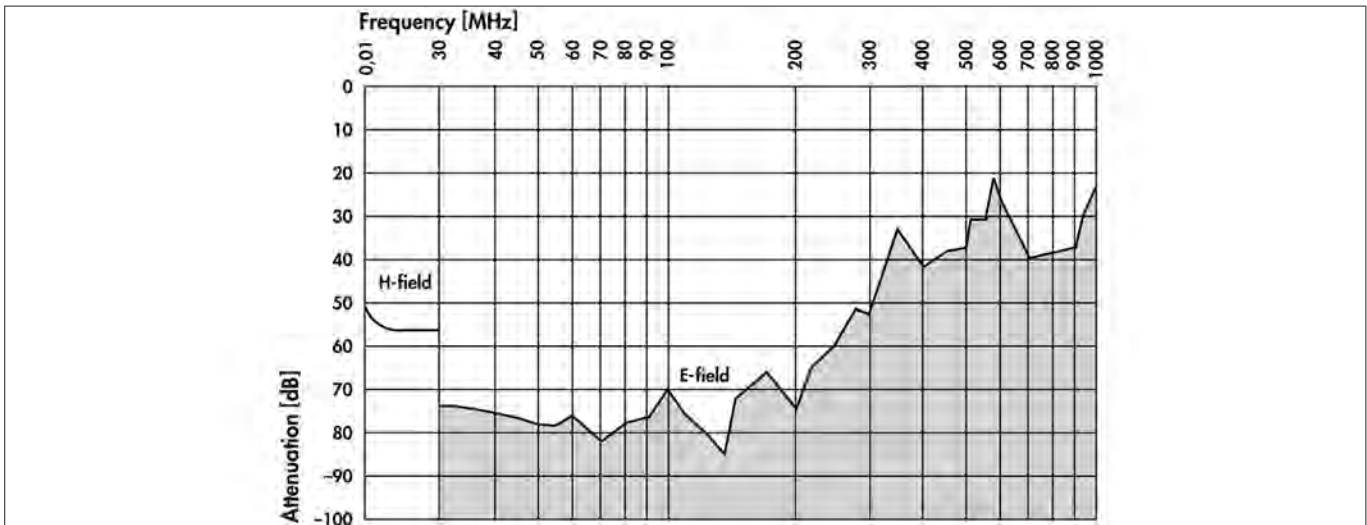

### 19" system cases RACKCASE, constructional design

- 19" system case consisting of extruded aluminium profiles and plates (apart from the support feet)
- hence all dimensions can be altered as per customer's request
- standard cover and bottom panels are silver (RAL 7001) lacquered, the other covering parts as required
- colours can also be adapted to individual design requirements
- the aluminium profiles and the inner surfaces of the covering panels are transparent passivated and thus electrically conductive
- EMC-screening by means of the extension set **RAC E** and the EMC-front panels **EGT F → N 30**

**1** = cover panel; **2** = module rail for part front panels and rear panels; **3** = centre module rail;  
**4** = side profile; **5** = side panel; **6** = foot; **7** = rear closing panel; **8** = handle; **9** = tilt foot; **10** = screwed foot

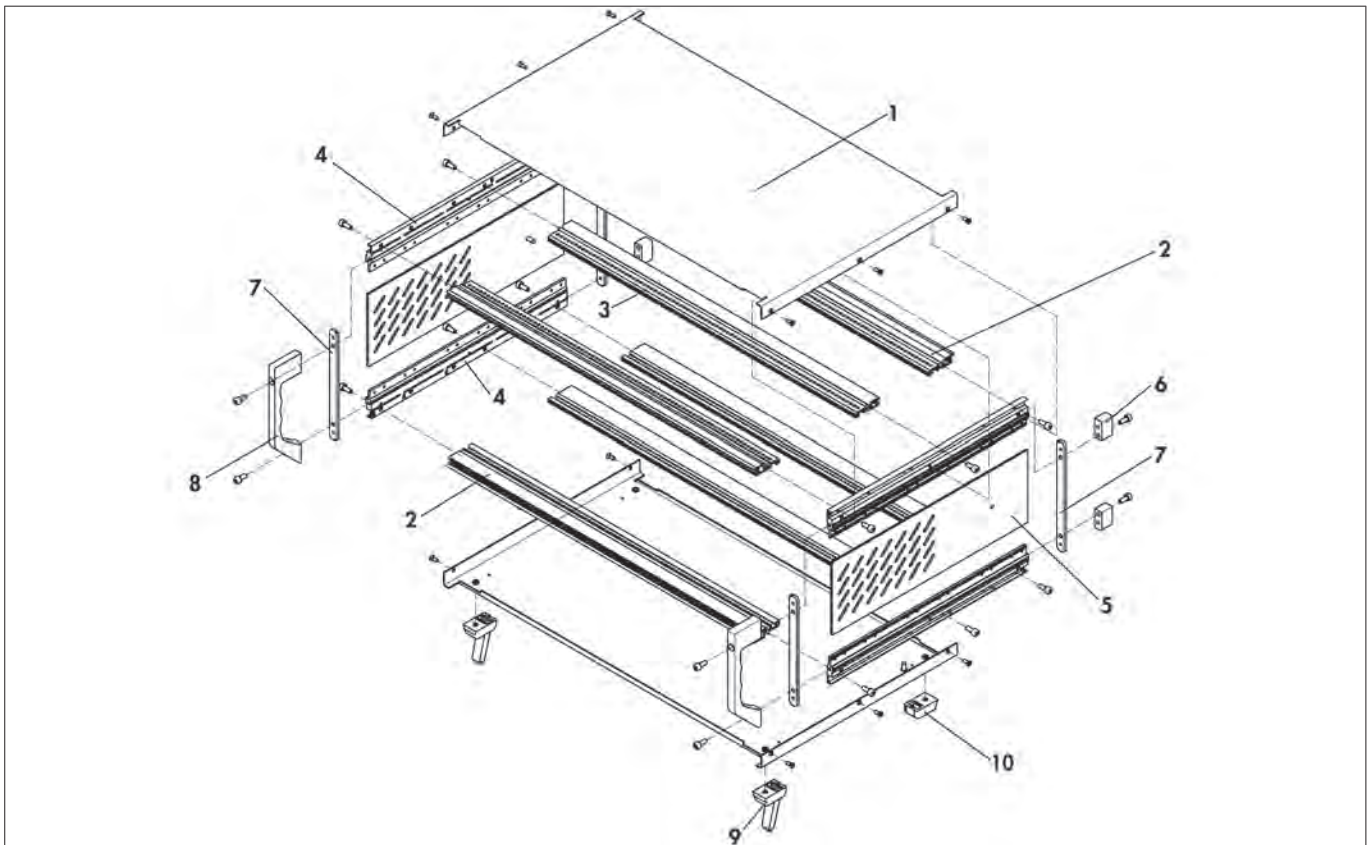

19" system cases RACKCASE

- further part units **HP** on request
- standard lacquered cover-and bottom panels silver-grey (**RAL 7001**)
- **contents of delivery:**  
 4 x module rails **GB 29**, 2 x module rails **GB 30**, 6 x threaded rails, 4 x side profiles **GB 35**, 2 x handles, 1 x bottom panel,  
 1 x cover panel, 2 x side panels, 4 x side covers, 4 x rear panel feet, 2 x screw-on feet, 2 x tilt feet, mounting material

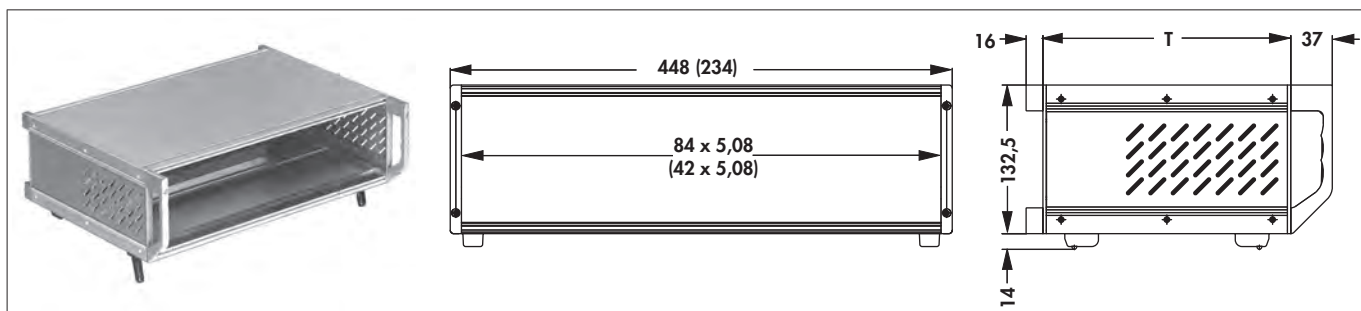

art. no.	HP	U	dim. [mm] T	art. no.	HP	U	dim. [mm] T
<b>RAC 342 220 ...</b>	42	3	220	<b>RAC 384 280 ...</b>	84	3	280
<b>RAC 342 280 ...</b>			380				
<b>RAC 342 380 ...</b>			480				
<b>RAC 384 220 ...</b>	84		220				

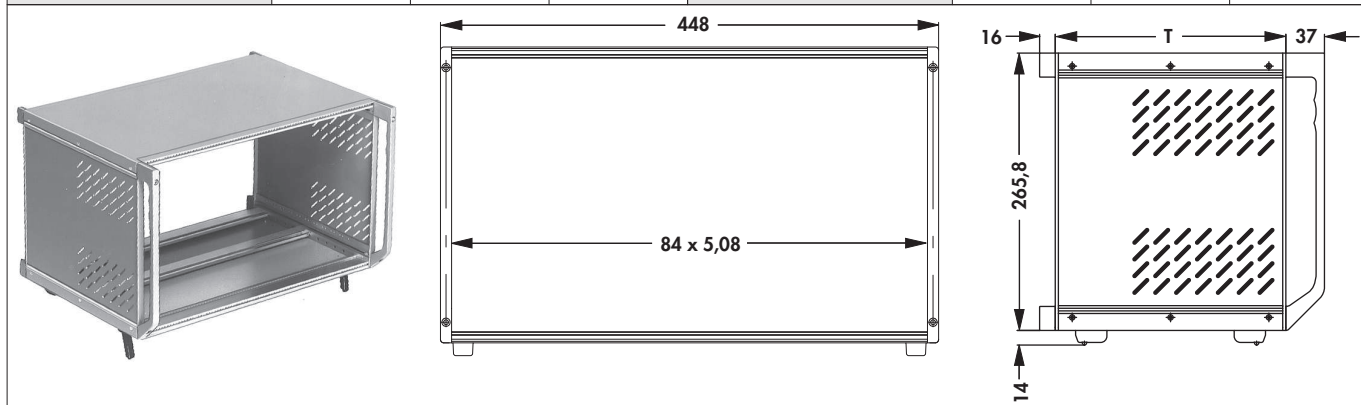

art. no.	HP	U	dim. [mm] T	art. no.	HP	U	dim. [mm] T
<b>RAC 6 220 ...</b>	84	6	220	<b>RAC 6 380 ...</b>	84	6	380
<b>RAC 6 280 ...</b>			280	<b>RAC 6 480 ...</b>			480

please indicate:

- ... colour of side panels and handles  
**TB** = turquoise blue (RAL 5018)  
**NB** = night blue (RAL 5022)  
**S** = black (RAL 9005)
- ... closed side panel (optional)  
**O** = closed
- ... ventilation slots (optional)  
**BL** = in bottom panel  
**DL** = in top panel  
**L** = in top- and bottom panel



**Accessories for 19" system cases RACKCASE**

**EMC expansion kit**

- creates an electrically conductive connection of the profiles and the covering parts
- suitable EMC front panels **EGT F** → N 30

**contents of delivery:**

4 x contact plates, 2 x earthing wire, 8 x contact springs with 10 contacts for 3 U, 16 x contact springs with 10 contacts for 6 U



<b>art. no.</b>	suitable for type	<b>art. no.</b>	suitable for type
<b>RAC E 3</b>	RAC 3	<b>RAC E 6</b>	RAC 6

**19" Fixing part**

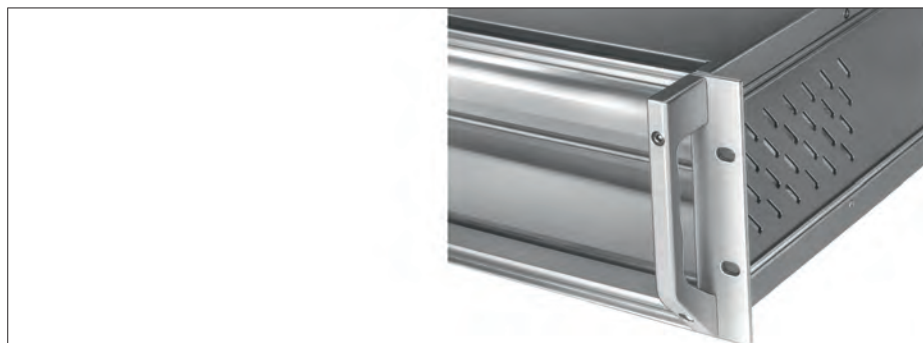

<b>art. no.</b>	suitable for type	<b>art. no.</b>	suitable for type
<b>RAC B 3</b>	RAC 3	<b>RAC B 6</b>	RAC 6