

## Ø1.00MM(0.039") WIRE-TO-WIRE CRIMP TERMINAL (A1)

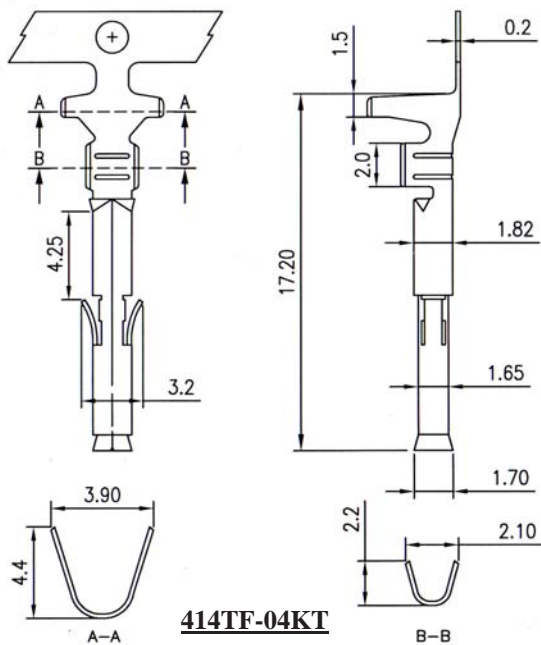

**414TF-04KT**

### SPECIFICATIONS

Accepts AWG# 18-22 Wire Range

**Insulation O.D.:** 3.4mm(max)

**Material:** Phosphor Bronze / Brass

**Finish:** Tin / Gold Plated

**Thickness:** 0.20mm

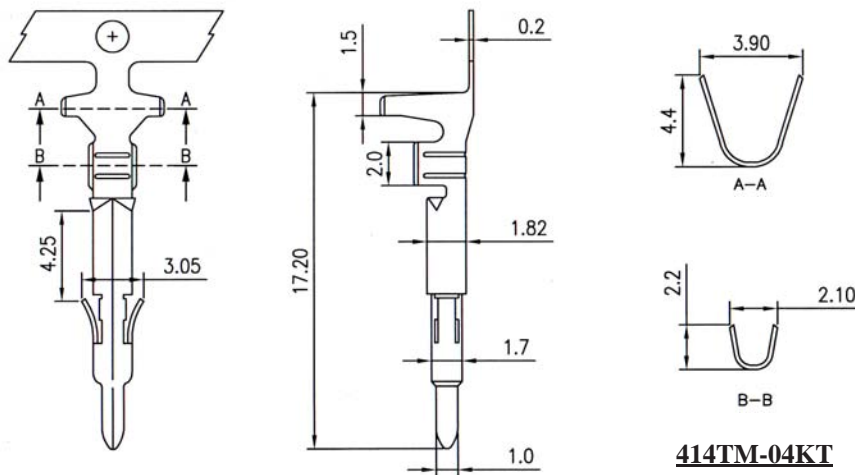

**414TM-04KT**

### ORDERING INFORMATION:

#### **P/N 414TF-04KT**

FEMALE CRIMP TERMINAL

PU= 4.000PCS/REEL

NOTE: ACCEPTS 414HM & 414HN HOUSINGS

#### **P/N 414TM-04KT**

MALE CRIMP TERMINAL

PU= 4.000PCS/REEL

NOTE: ACCEPTS 414HF HOUSING

**Ø1.00MM WIRE 4.14MM SPACING WIRE-TO-WIRE SYSTEM (A2)**

**P/N 414HF-1X1HW**

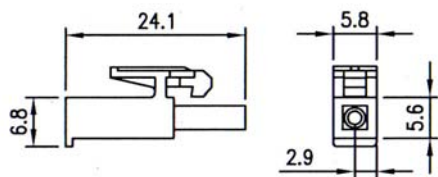

**P/N 414HF-1X2HW**

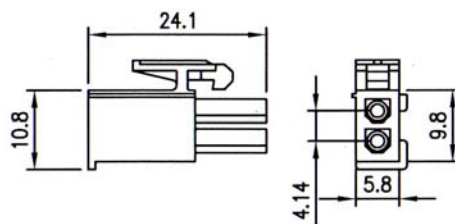

**P/N 414HF-1X3HW**

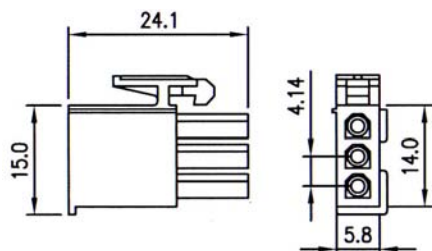

**P/N 414HF-2X2HW**

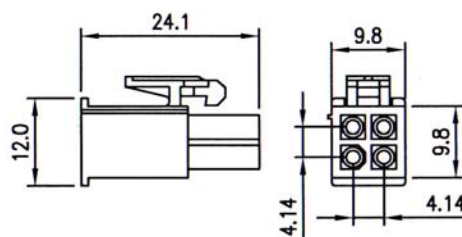

**P/N 414HF-2X3HW**

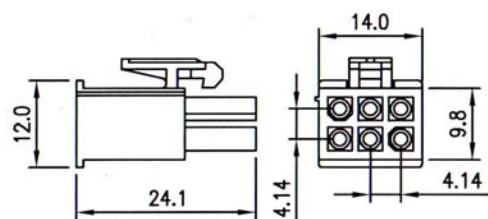

**P/N 414HF-3X3HW**

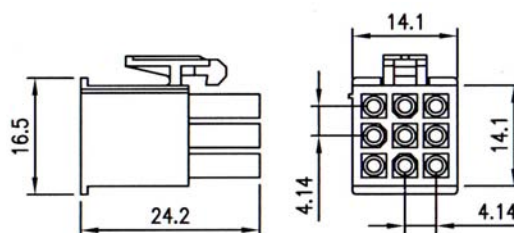

**P/N 414HF-3X4HW**

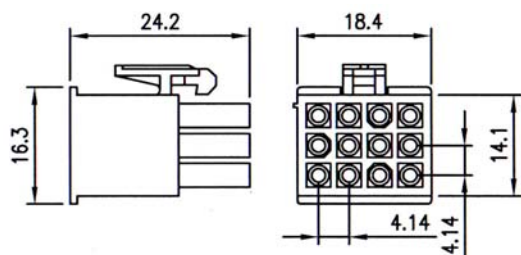

**P/N 414HF-3X5HW**

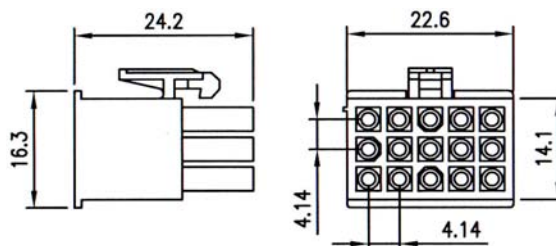

**ORDERING INFORMATION:**

**P/N 414HF - x x x H W**

NOTE: ACCEPTS 414TF TERMINAL

**SPECIFICATIONS**

**Rated Voltage:** 500V AC,DC

**Rated Current:** 3A

**Withstand Voltage:** 650V AC/minute

**Insulation Resistance:** 1000M Ω/min

**Temperature Range:** -40°C to + 105°C

**HOUSING**

**Material:** Nylon 66, UL 94V-2

**All materials must be RoHS compliant.**

**Ø1.00MM WIRE 4.14MM SPACING WIRE-TO-WIRE SYSTEM (A3)**

**P/N 414HM-1X1HW**

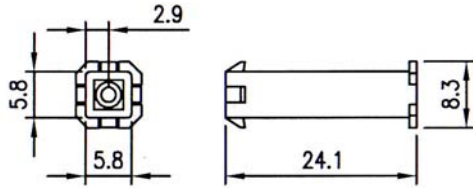

**P/N 414HM-1X2HW**

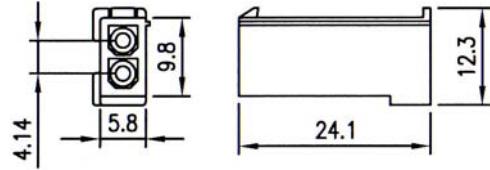

**P/N 414HM-1X3HW**

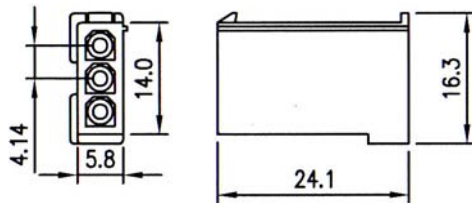

**P/N 414HM-2X2HW**

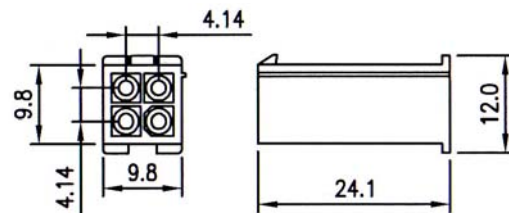

**P/N 414HM-2X3HW**

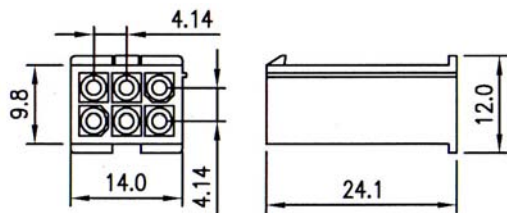

**P/N 414HM-3X3HW**

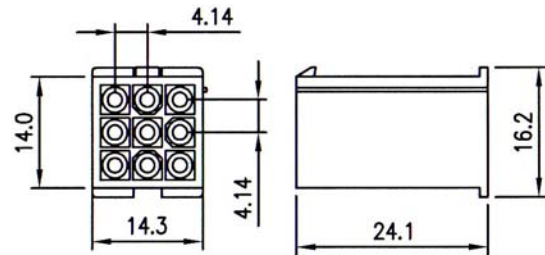

**P/N 414HM-3X4HW**

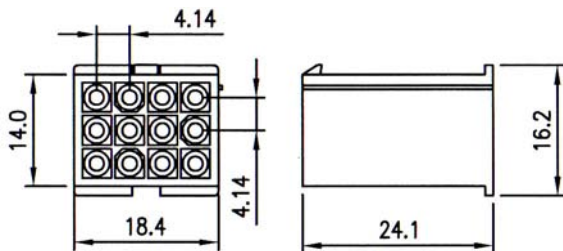

**P/N 414HM-3X5HW**

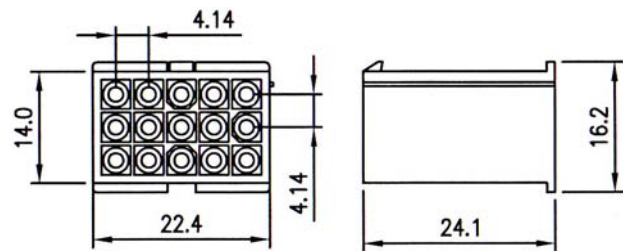

**ORDERING INFORMATION:**

**P/N 414HM - x x x H W**

NOTE: ACCEPTS 414TM TERMINAL

**SPECIFICATIONS**

**Rated Voltage:** 500V AC,DC

**Rated Current:** 3A

**Withstand Voltage:** 650V AC/minute

**Insulation Resistance:** 1000M Ω/min

**Temperature Range:** -40°C to + 105°C

**HOUSING**

**Material:** Nylon 66, UL 94V-2

**All materials must be RoHS compliant.**

## Ø1.00MM WIRE 4.14MM SPACING WIRE-TO-WIRE SYSTEM (A4)

**P/N 414HN-1X2HW**

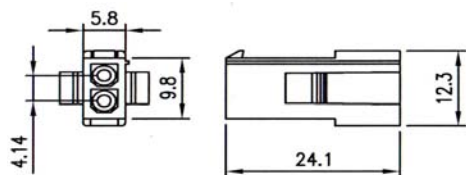

**P/N 414HN-1X3HW**

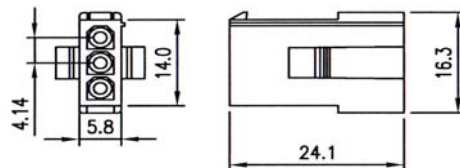

**P/N 414HN-2X2HW**

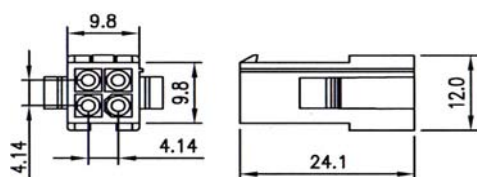

**P/N 414HN-2X3HW**

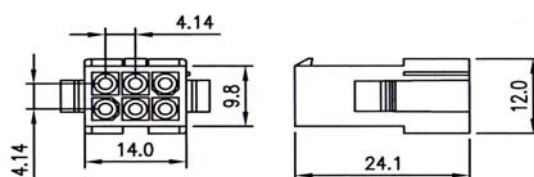

**P/N 414HN-3X3HW**

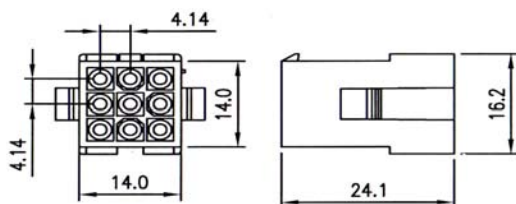

**P/N 414HN-3X4HW**

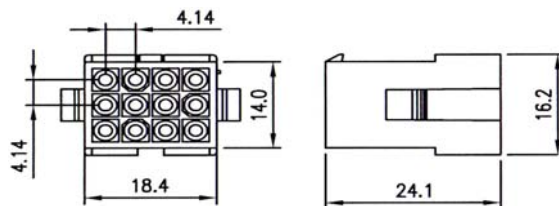

**P/N 414HN-3X5HW**

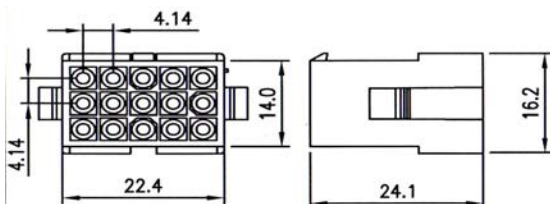

### ORDERING INFORMATION:

**P/N 414HN - x x x H W**

NOTE: ACCEPTS 414TM TERMINAL

### SPECIFICATIONS

**Rated Voltage:** 500V AC,DC

**Rated Current:** 3A

**Withstand Voltage:** 650V AC/minute

**Insulation Resistance:** 1000M Ω/min

**Temperature Range:** -40°C to + 105°C

### HOUSING

**Material:** Nylon 66, UL 94V-2

**All materials must be RoHS compliant.**

## Ø1.30MM(0.051") WIRE-TO-WIRE CRIMP TERMINAL (B1)

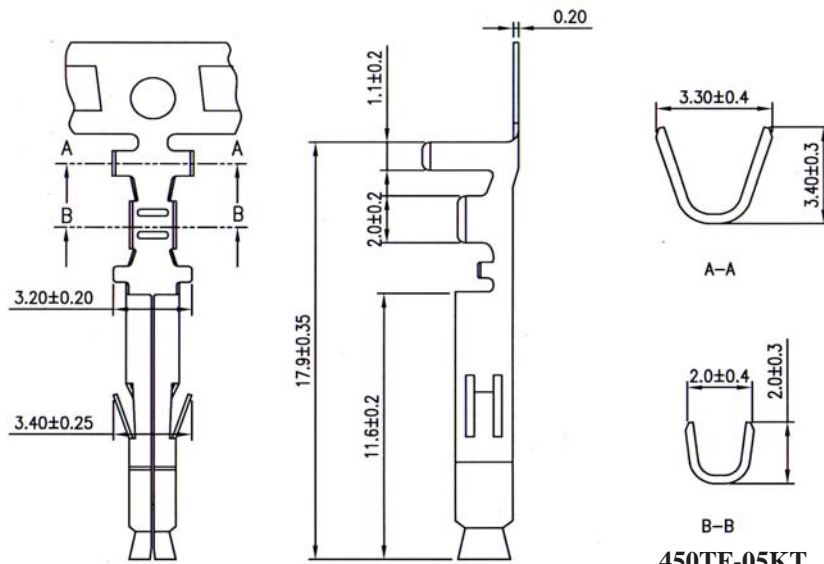

### SPECIFICATIONS

Accepts AWG# 18-22 Wire Range

**Insulation O.D.:** 2.7mm(max)

**Material:** Brass

**Finish:** Tin Plated

**Thickness:** 0.20mm

A-A

B-B

**450TF-05KT**

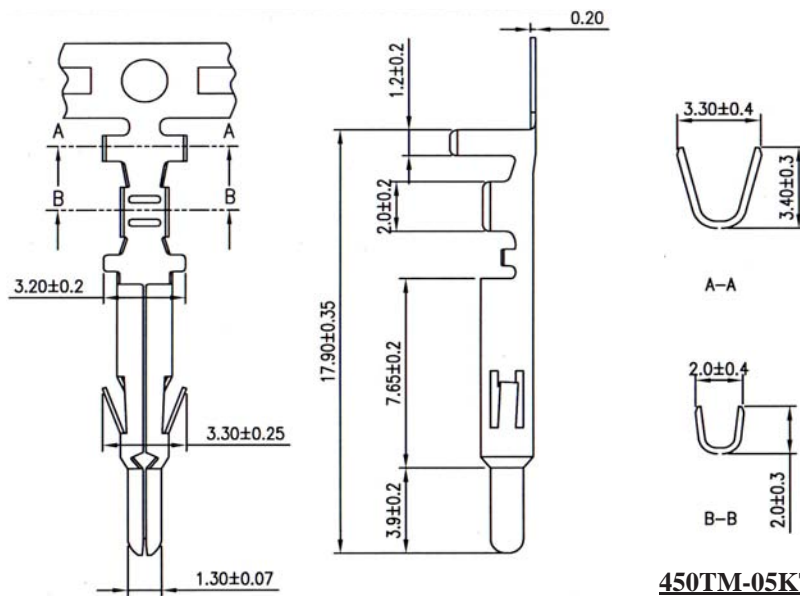

A-A

B-B

**450TM-05KT**

### ORDERING INFORMATION:

**P/N 450TF-07KT**

FEMALE CRIMP TERMINAL  
PU= 7.000PCS/REEL

NOTE: ACCEPTS 450HF HOUSING

**P/N 450TM-07KT**

MALE CRIMP TERMINAL  
PU= 7.000PCS/REEL

NOTE: ACCEPTS 450HM & 450HN HOUSINGS

## Ø1.30MM WIRE 4.50MM SPACING WIRE-TO-WIRE SYSTEM (B2)

P/N 450HF-1X2HW

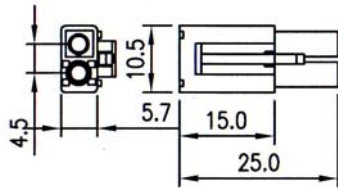

P/N 450HF-1X3HW

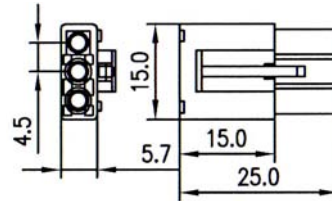

P/N 450HF-1X4HW

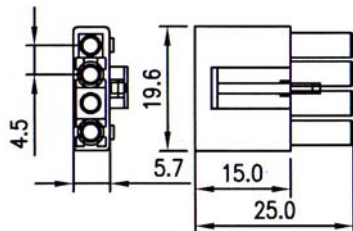

P/N 450HF-2X2HW

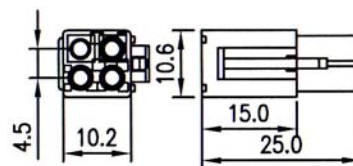

P/N 450HF-2X3HW

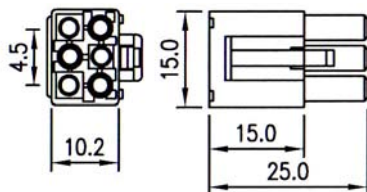

P/N 450HF-3X3HW

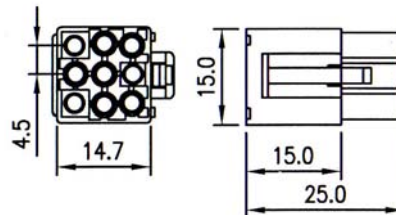

P/N 450HF-3X4HW

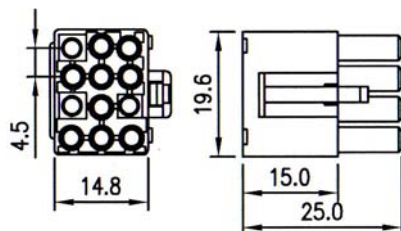

P/N 450HF-3X5HW

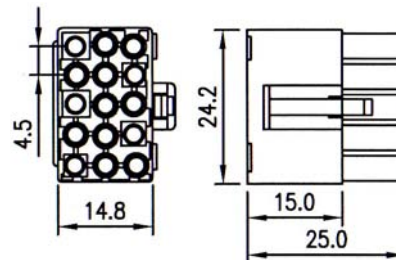

### ORDERING INFORMATION:

**P/N 450HF - x x x H W**

NOTE: ACCEPTS 450TF TERMINAL

### SPECIFICATIONS

**Rated Voltage:** 300V AC,DC

**Rated Current:** 6A

**Withstand Voltage:** 1500V AC/minute

**Insulation Resistance:** 1000M Ω/min

**Temperature Range:** -25°C to +85°C

### HOUSING

**Material:** Nylon 66, UL 94V-0

**All materials must be RoHS compliant.**



## Ø1.30MM WIRE 4.50MM SPACING WIRE-TO-WIRE SYSTEM (B3)

**P/N 450HM-1X2HW**

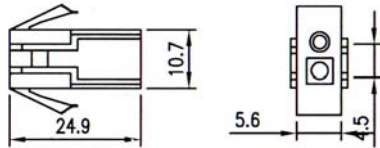

**P/N 450HM-1X3HW**

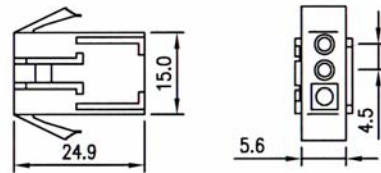

**P/N 450HM-1X4HW**

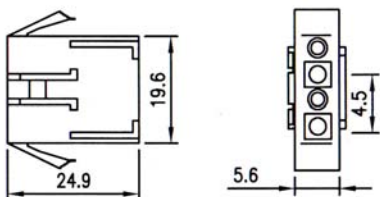

**P/N 450HM-2X2HW**

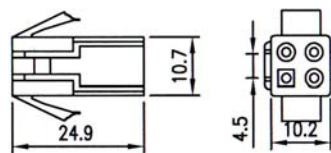

**P/N 450HM-2X3HW**

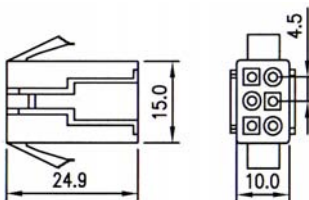

**P/N 450HM-3X3HW**

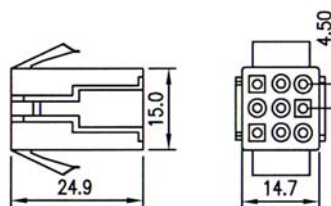

**P/N 450HM-3X4HW**

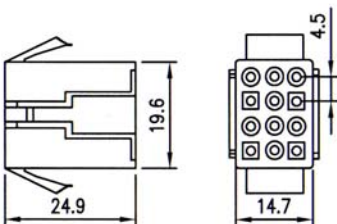

**P/N 450HM-3X5HW**

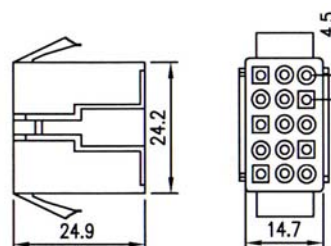

### ORDERING INFORMATION:

**P/N 450HM - x x x H W**

NOTE: ACCEPTS 450TM TERMINAL

### SPECIFICATIONS

**Rated Voltage:** 300V AC,DC

**Rated Current:** 6A

**Withstand Voltage:** 1500V AC/minute

**Insulation Resistance:** 1000M Ω/min

**Temperature Range:** -25°C to +85°C

### HOUSING

**Material:** Nylon 66, UL 94V-0

**All materials must be RoHS compliant.**

**Ø1.30MM WIRE 4.50MM SPACING WIRE-TO-WIRE SYSTEM (B4)**

**P/N 450HN-1X2HW**

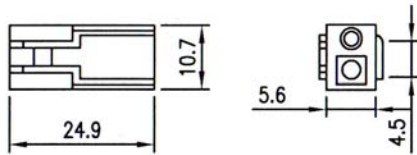

**P/N 450HN-1X3HW**

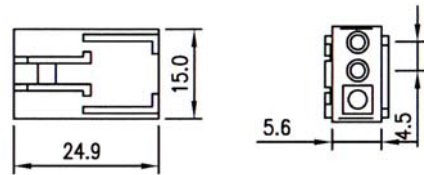

**P/N 450HN-1X4HW**

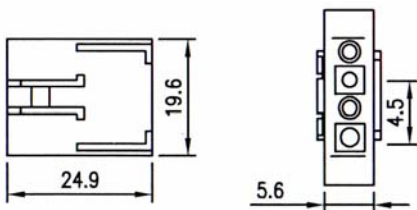

**P/N 450HN-2X2HW**

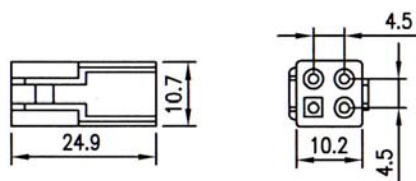

**P/N 450HN-2X3HW**

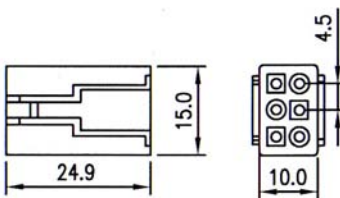

**P/N 450HN-3X3HW**

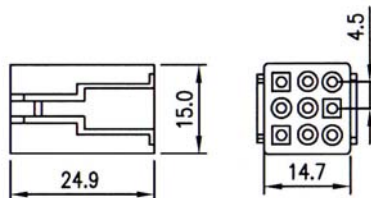

**P/N 450HN-3X4HW**

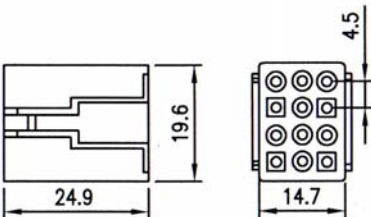

**P/N 450HN-3X5HW**

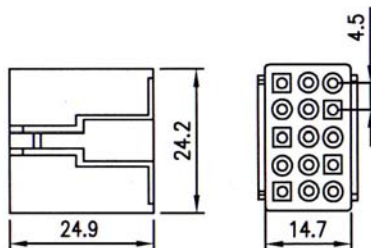

**ORDERING INFORMATION:**

**P/N 450HN - x x x HW**

NOTE: ACCEPTS 450TM TERMINAL

**SPECIFICATIONS**

**Rated Voltage:** 300V AC,DC

**Rated Current:** 6A

**Withstand Voltage:** 1500V AC/minute

**Insulation Resistance:** 1000M Ω/min

**Temperature Range:** -25°C to +85°C

**HOUSING**

**Material:** Nylon 66, UL 94V-0

**All materials must be RoHS compliant.**