

TML-3 SERIES

Tact Switch Illuminated

ILLUMINATED SWITCH



HOW TO ORDER

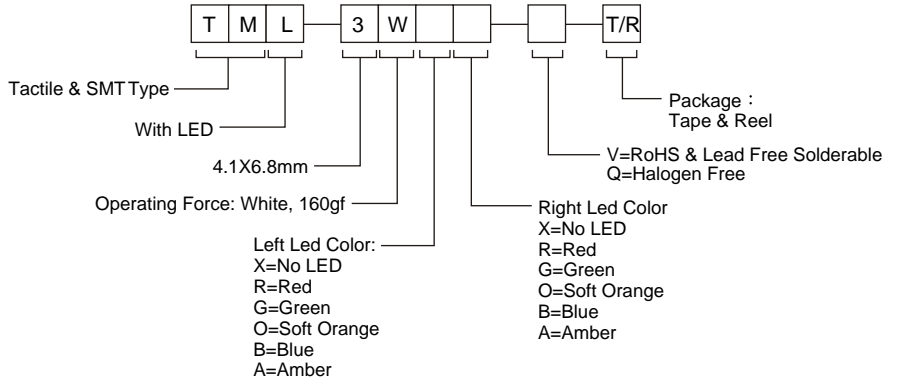

SPECIFICATION

MECHANICAL

Operation Force: 160+80gf/-30gf
 Stroke : 0.20±0.10mm

ENVIRONMENTAL

Operation Temperature Range : -20°C to +70°C
 Storage Temperature Range : -30°C to +80°C

ELECTRICAL

Electrical Life: 50,000 cycles.
 Rating: 50mA, 12VDC

PACKAGE

Tape & Reel: 3000 pcs/reel

Please contact the sales in charge for other LED colors requirement.

CIRCUIT

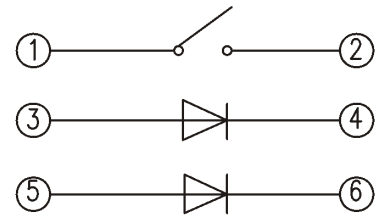

TML-3

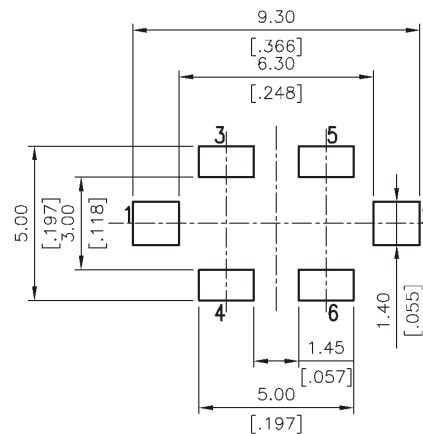
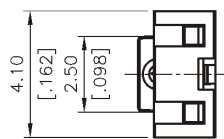
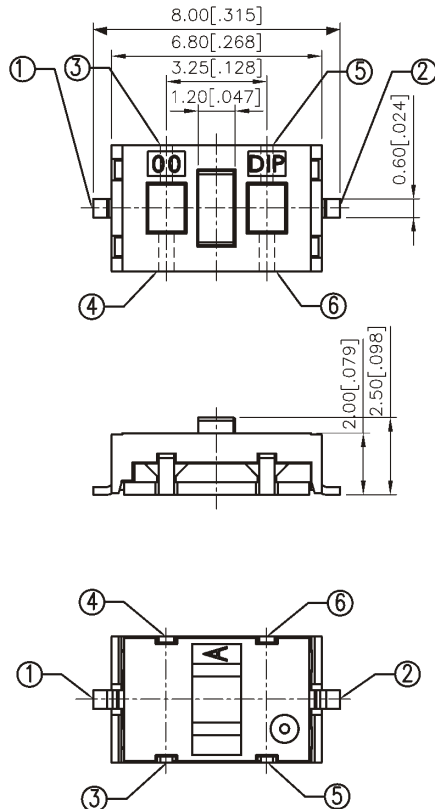

P.C.B. LAYOUT