

## SPECIFICATIONS:

CONTACT RATING: AC/DC 150V 130mA.  
ELECTRICAL LIFE: 15,000 cycles at full load  
CONTACT RESISTANCE: 25mΩ max. initial.  
INSULATION RESISTANCE: 100MΩ max.  
DIELECTRIC STRENGTH: 1,000 V RMS @ sea level.  
OPERATING TEMPERATURE: -30°C to +80°C.  
STOPS: Adjustable 2 through 12 position -30°C indexing.

## MATERIALS:

SHAFT: Aluminum.  
COVER: PA.  
BASE: PA.  
CONTACTS: PBS+Ag.  
TERMINALS: Brass+Ag.  
MOVEMENT: PA.  
SPRING: SUS.

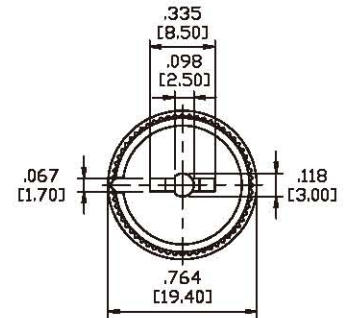
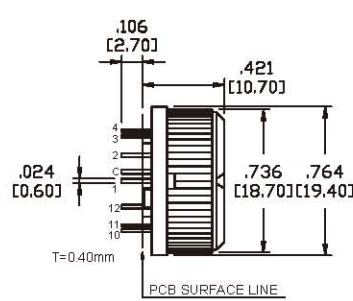
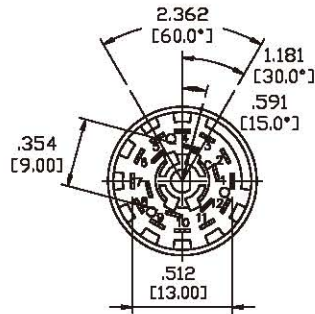

Model No.	Switching Position
8405-1	1P-12Pos

Schematic

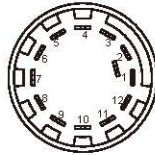
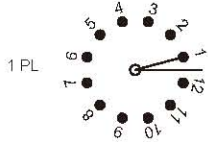

Model No.	Switching Position
8405-2	2P-6Pos

Schematic

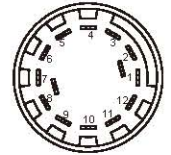
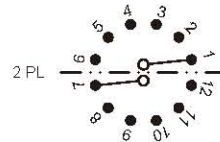

Model No.	Switching Position
8405-3	3P-4Pos

Schematic

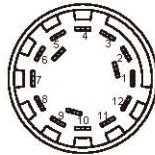
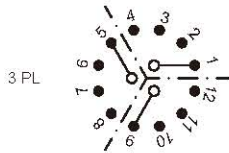

## SHAFT OPTIONS

A = With Shaft  
B = Without Shaft

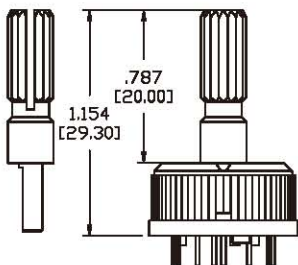

## P.C.MOUNTING

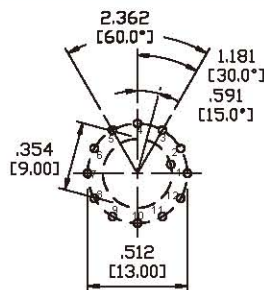

8405-1 MODELS



8405-2 MODELS



8405-3 MODELS

## SPECIFICATIONS:

CONTACT RATING: 350mA @ 110V (AC or DC).  
 150mA @ 250V (AC or DC).  
 CURRENT CARRYING CAPACITY: 5A continuous. (Non-switching)  
 ELECTRICAL LIFE: 15000 cycles at full load up to 30,000 detent operations.  
 CONTACT RESISTANCE: 20mΩ max. initial.  
 DIELECTRIC STRENGTH: 1000 V RMS @ sea level.  
 OPERATING TEMPERATURE: -20°C to +85°C.  
 STOPS: Adjustable 2 through 12 position -30°C indexing.

## MATERIALS:

SHAFT: Glass filled nylon, color-gray.  
 COVER: Glass filled nylon, color-gray.  
 BASE: Glass filled nylon, color-gray.  
 CONTACTS: Brass, silver plated.  
 TERMINALS: Brass, silver plated.  
 HARDWARE: Nut-Zinc, nickel plated.  
 LOCKWASHER: Steel, bright Zinc plated.  
 STOP RING: Brass, nickel plated.

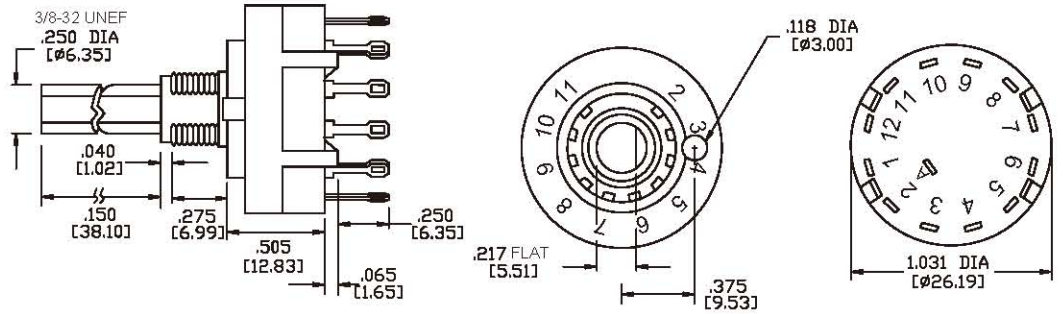

Model No.	Switching Position
8404-1	1P-12Pos

Schematic

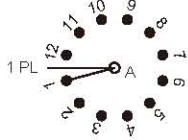

TERM. NOS. MOLDED ON HOUSING

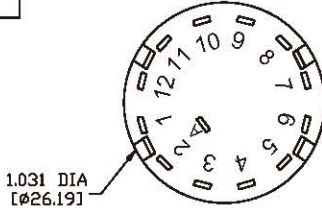

Model No.	Switching Position
8404-2	2P-6Pos

Schematic

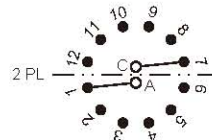

TERM. NOS. MOLDED ON HOUSING

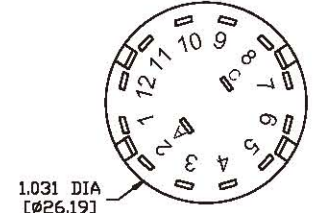

Model No.	Switching Position
8404-3	3P-4Pos

Schematic

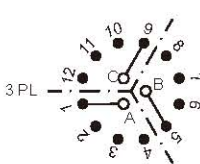

TERM. NOS. MOLDED ON HOUSING

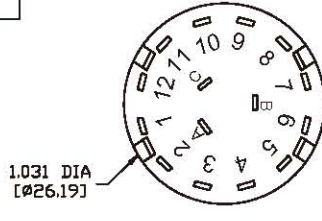

Model No.	Switching Position
8404-4	4P-3Pos

Schematic

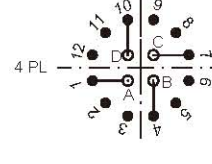

TERM. NOS. MOLDED ON HOUSING

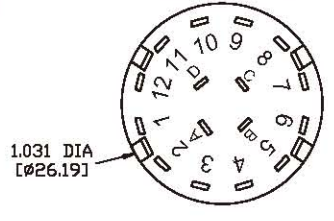

## PANEL MOUNTING

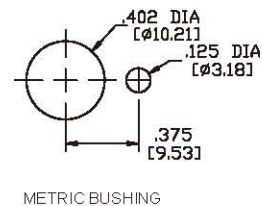
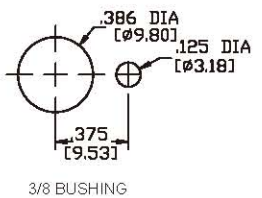

## P.C.MOUNTING

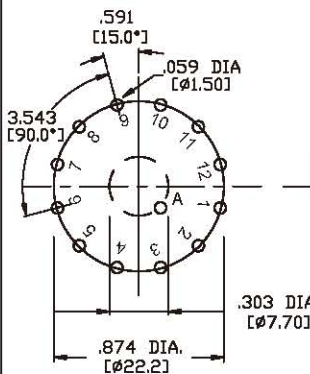

8404-1 MODELS

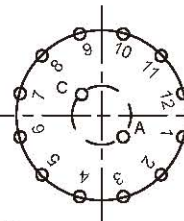

8404-2 MODELS

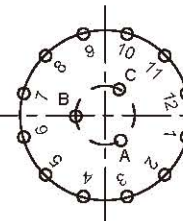

8404-3 MODELS

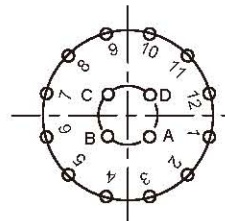

8404-4 MODELS

ACTUATOR OPTIONS

Actuator	DIM"A"	DIM"L"
38	1.496 [38.00]	1.181 [30.00]
29	1.142 [29.00]	.827 [21.00]
21	.827 [21.00]	.512 [13.00]
18	.709 [18.00]	.394 [10.00]
15	.591 [15.00]	.276 [7.00]

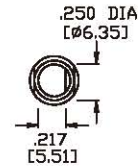
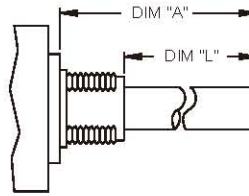

BUSHING OPTIONS

E STD.

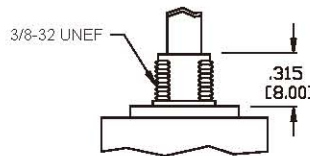

TERMINATION OPTIONS

B STD.

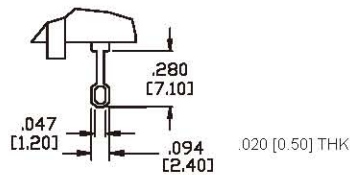

C PRINTED CIRCUIT

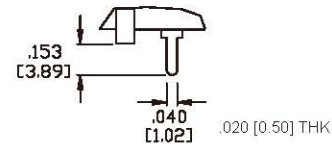

NUT

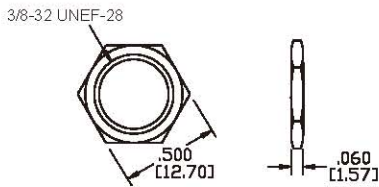

LOCK WASHER

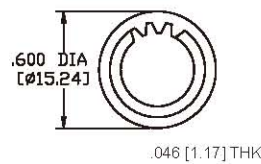

STOP RING

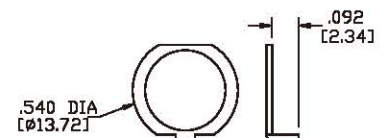

CONTACT OPTIONS

NS STD.

Non-Shorting Contacts: Break before make

SC

Shorting Contacts: Make before break

HOW TO ORDER

